

Land at Dundas Street/Fettes Row/ Eyre Terrace/Royal Crescent 1st Public Consultation Event - September 2015 Feedback Questionnaire

We are keen to hear your views on the following key issues. Comments received will be used to inform the preparation of initial development options for the site.

If you wish to make any comments, please fill out the form below and place it in the comments box at the exhibition or send to GVA, Quayside House, 127 Fountainbridge, Edinburgh, EH3 9QG. Comments should be made no later than **2 October 2015**.

YOUR FEEDBACK

Q.1 Do you support the principle of redeveloping the site for residential-led mixed uses?

Yes No Neutral

CONNECTIONS

Q.2 How would you like to be able to move through and around the site? Please write your feedback below or draw on the plan.

.....

.....

.....

.....

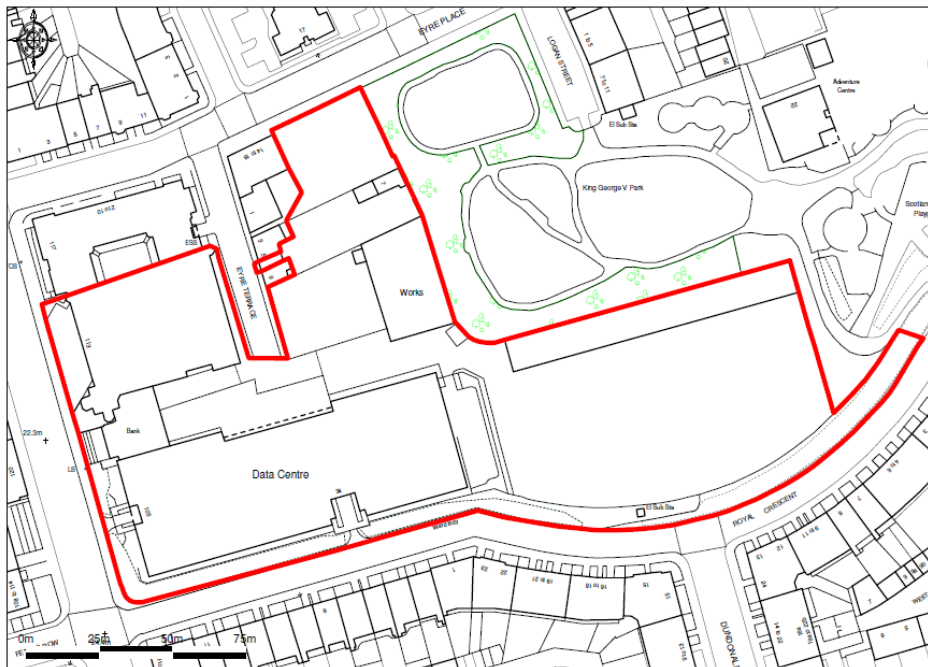

SPACES

Q.3 What types of new spaces would you like to see on the site?

.....

.....

.....

.....

.....

Q.4 The site lies adjacent to King George V Park. Would you like to see new pedestrian linkages through the site into the park?

Yes No Neutral

If yes, please mark on the plan below if you have a particular preference to where new pedestrian linkages into the park could be located.

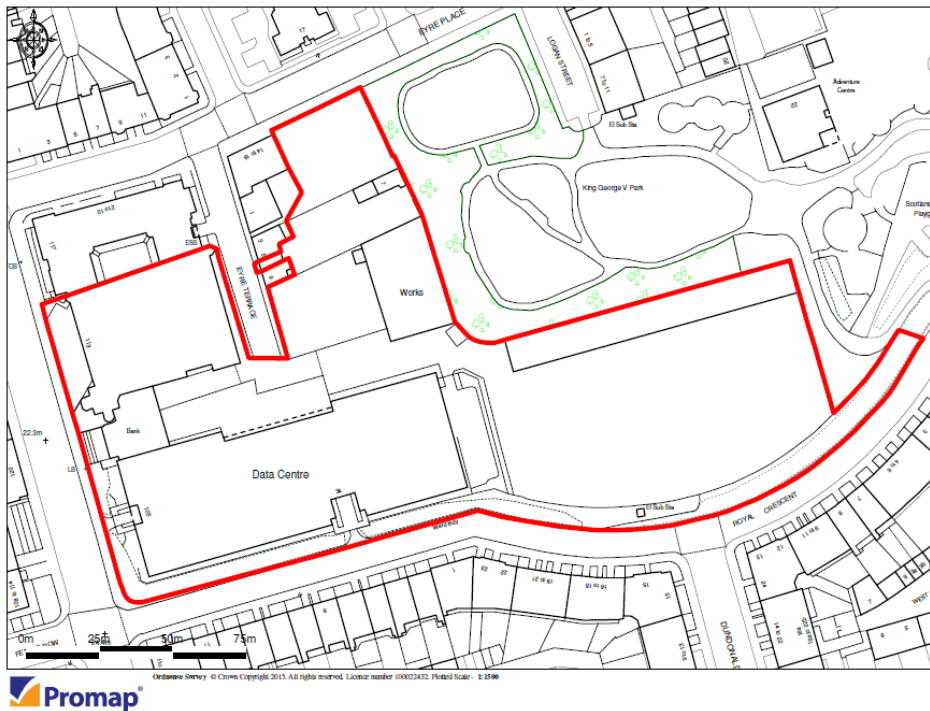

Q.5 Should new development be designed to provide good natural surveillance to King George V Park?

Yes No Neutral

USES, BUILDING AND SITE FEATURES

Q. 6 Thinking of existing uses, facilities and amenities in the local area, please tick what uses you would like to see on the site. Please tick all that apply:

- Residential;
- Affordable Housing;
- Active ground floor uses fronting Dundas Street;
- Active ground floor uses fronting Eyre Place;
- Offices;
- Retail;
- Hotel;
- Care Home;
- Student Housing;
- Other? Please specify below

.....
.....
.....
.....

Q.7 What are your views on the existing buildings on the site in terms of their form and appearance? Do you consider that they contribute positively to the character and appearance of the surrounding area?

.....
.....
.....
.....
.....

Q.8 Are there are features on the existing site you would like to see retained?

.....
.....
.....
.....
.....

Please elaborate on any of your answers given above and/or provide any additional comments below.

Thank you for your contribution to this public consultation exercise.

So we can inform you of the 2nd public event and also gain an understanding of who attended the exhibition we would be grateful if you could record your details below:

Name/organisation.....

Address.....

Postcode.....

Email.....

We would like to reassure you that your personal details will only be used for the purpose of this public consultation/forthcoming planning application, and in accordance with the Data Protection Act, will not be passed to any third party unless we have your permission to do so by law.

Please note that all comments sent to GVA in respect of this pre-application consultation are not representations to City of Edinburgh Council. There will be an opportunity to make representations to the Council when a formal application is made.